

halfords

2 Seat Trailer



**Owner's manual
and
safety instructions**

Owner's Manual

Every effort has been made to ensure your trailer is of top quality and proven safe design, ready to provide you with many years of safe, happy use. Please read this manual and instructions fully before assembly and use.

Please keep this manual for future reference. If you sell or give this product to someone else, please include this Owner's Manual, and ask the new owner to read the instructions thoroughly before using.

⚠ WARNING Your trailer is designed for the safe, passive transportation of 1 child or 2 children between 12 months and 6 years of age and weighing no more than 22kg (48lbs) each. It designed only for attachment to an adult pedal cycle and for use at a leisurely pace. Its design is not consistent with off-road, jumping or competitive cycling.

Any such unauthorized use may cause a critical failure of the trailer resulting in possible death or injury to the passenger(s) and/or rider.

⚠ WARNING Not for use with children under 12 months old! Children must be able to support their own heads!

⚠ WARNING To prevent injury, please use extreme care when folding and unfolding this product!

PRIOR TO ASSEMBLY

Your Halfords trailer is 95% factory assembled. You need only, install the safety flag, and attach the wheels before it is ready to use. This initial assembly should only take around 10-15 minutes, after which all you need do now is familiarize yourself with the essential safety information within this document and you're ready to go.

- Assembly and attachment must only be carried out by an adult.
- Check that all parts are present. If any parts are missing or damaged, please contact one of our Customer Service Representatives by phone at 01332 274242, or by e-mail at customer.sevice@moorelarge.co.uk

⚠ WARNING Immediately discard all plastic bags and plastic wrapping materials!

⚠ WARNING Never allow children to assemble, fold, or disassemble this unit!

PARTS LIST

- | | |
|---|--|
| 1 | Frame with canopy, sling seat with twin 5-point safety harnesses, tow bar, tow bar coupler and rear wheel brackets attached. |
| 1 | 2-in-1 Rain cover |
| 1 | Safety flag with pole |
| 2 | 20" Rear wheels |

No tools are required to assemble this trailer. However, for those bikes without a quick-release axle on the rear wheel, an adjustable wrench is required to attach the coupler plate.

⚠ WARNING Before using, be sure the product is correctly assembled!

ASSEMBLY INSTRUCTIONS

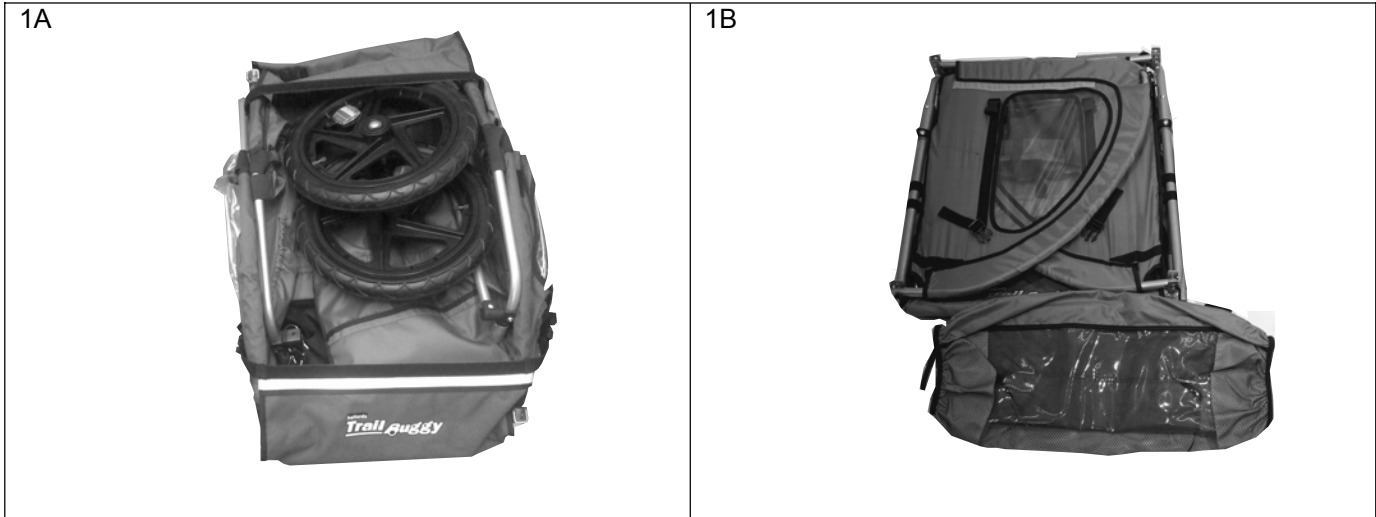

- 1A. Remove all of the contents from inside the carton and place them on a clean flat surface. Check all the contents against the parts list on page 1. Check the contents also for damage.
- 1B. Set the wheels to the side and remove the black plastic protective caps from the ends of the axles. Remove the rain canopy and flag pole assembly from inside the trailer.

STEP 2 Assemble the canopy frame

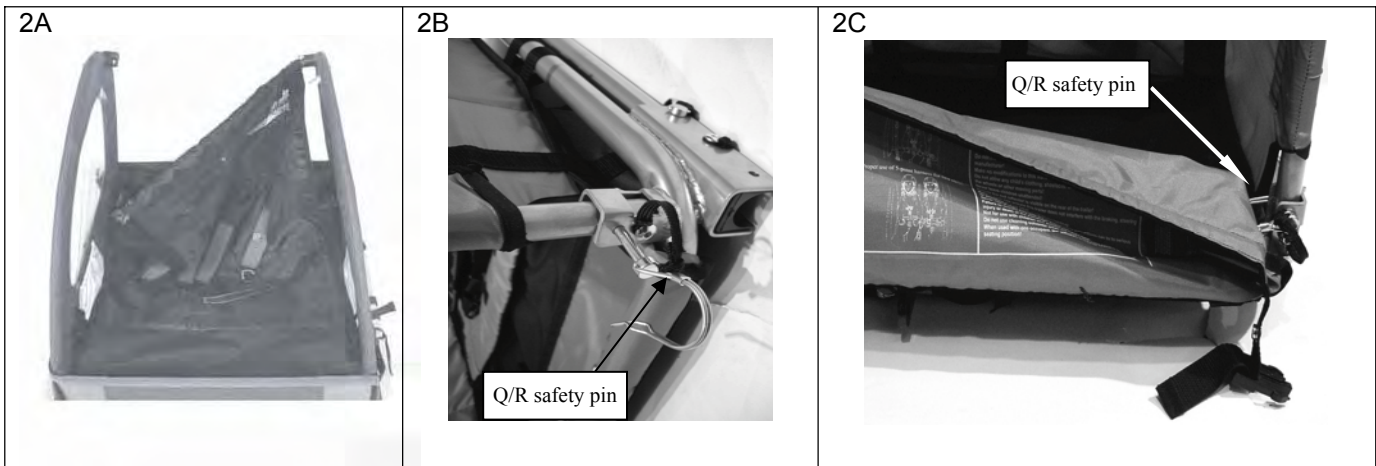

- 2A. Lift the left side panel with the frame joiner housing upward so that the right side panel is visible. Lift the right side panel to expose the crossbar and slide the crossbar through the sling seat. Locate the end of the crossbar into the joiner housing on the left panel.
- 2B. Insert the quick release safety pin through the end of the cross bar & joiner housing and snap closed.
- 2C. Insert the quick release safety pins through the front and rear of each panel at the base and snap closed to secure the sides.

⚠ WARNING Ensure all 5 quick release safety pins are securely locked before continuing!

STEP 3 Adjust the sling seat

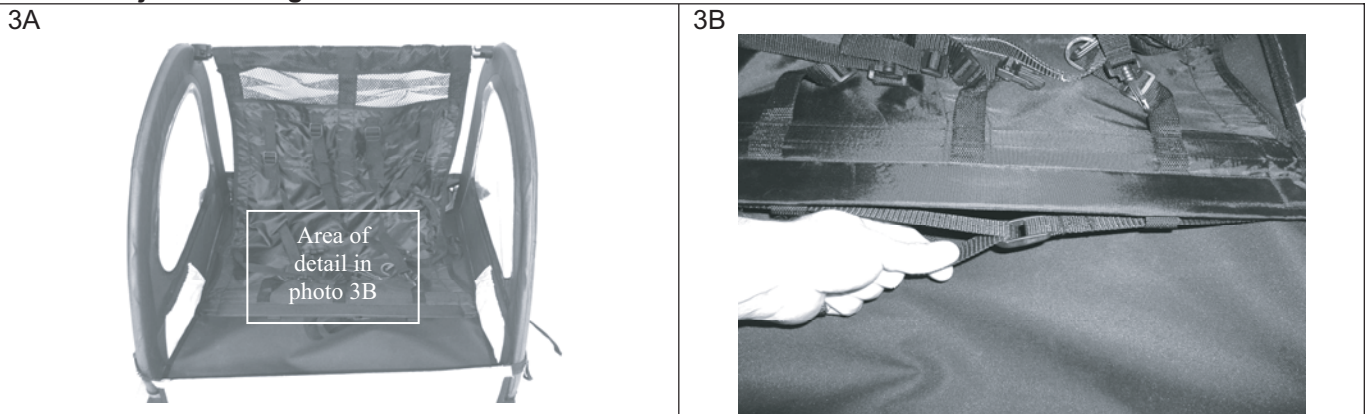

- 3A. Front view of the trailer with the crossbar secured in place.
- 3B. To provide more comfort, the sling seat can be adjusted by pulling on one or both sets of straps that run underneath the bottom of the seat. Loosen the straps to allow the trailer to fold flat.

STEP 4 Attach the 2-in-1 canopy

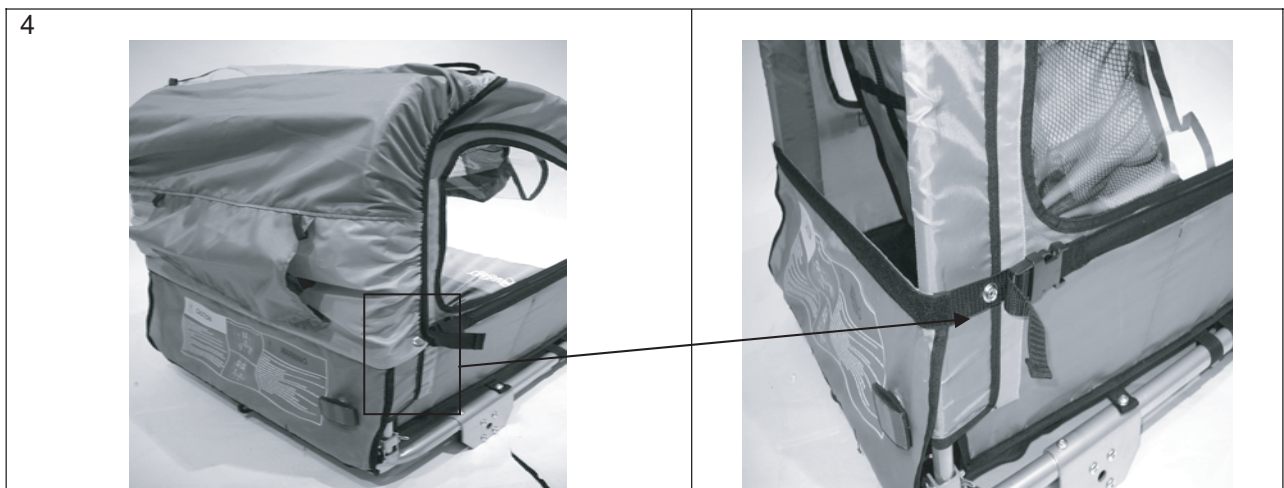

4. Lay the canopy over the top of the trailer frame with the large window toward the front. Fold back the top edge of the canopy and attach the two rear snaps. Seal the canopy to the rear flap with the hook & loop tape.

STEP 5 Complete the 2-in-1 canopy attachment

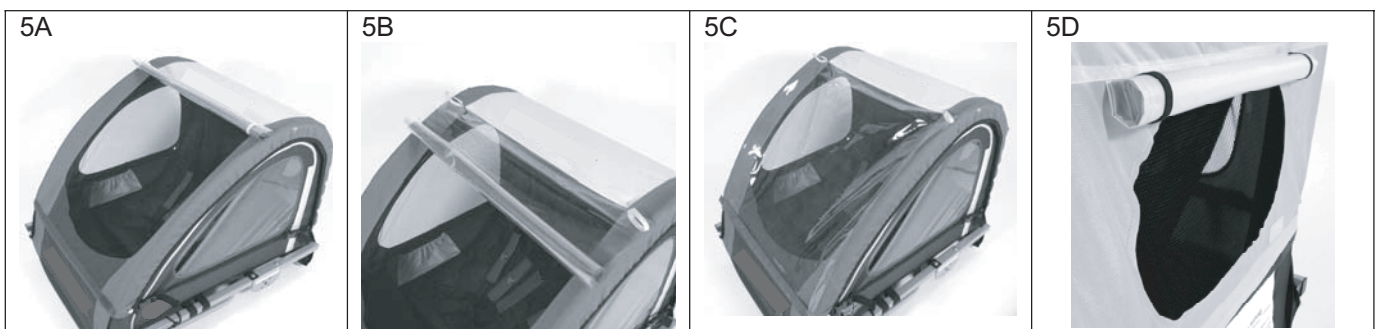

- 5A. Attach the two snaps at the front corners of the canopy, and join the front flaps.
- 5B. The rain shield may be rolled down by undoing the elastic loops.
- 5C. Secure the rain shield along the bottom edge of the 2-in-1 canopy.
- 5D. The rear window cover can be rolled up to provide more air flow through the trailer.

STEP 6 Attach the wheels to the quick-release brackets and make sure they are secure

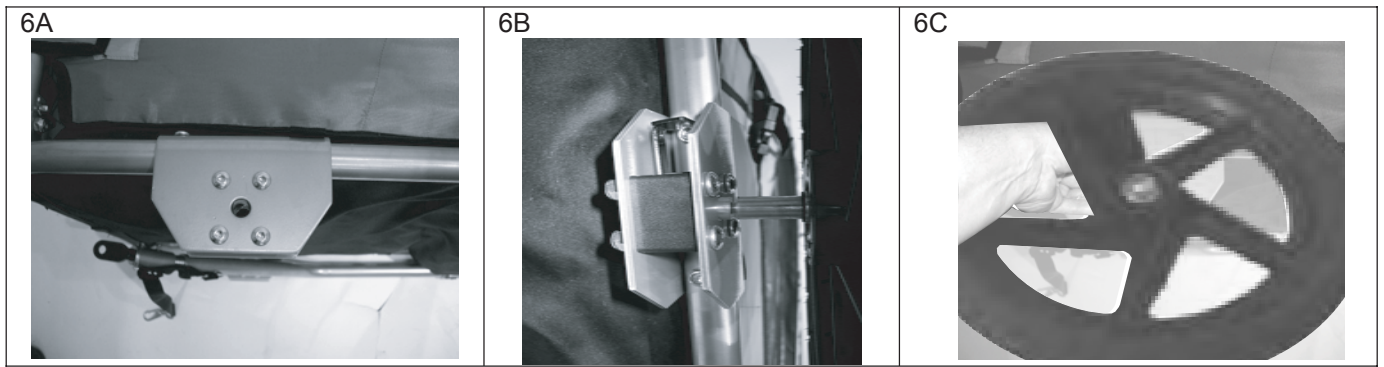

- 6A. Locate the rear wheel brackets on each side of the trailer and read the warnings carefully.
- 6B. Push one wheel axle completely through the bracket hole until you hear the axle click into place.
- 6C. **IMPORTANT!** Pull firmly on each wheel to ensure the lock mechanisms are securely engaged!

STEP 7 Extend and secure the tow bar

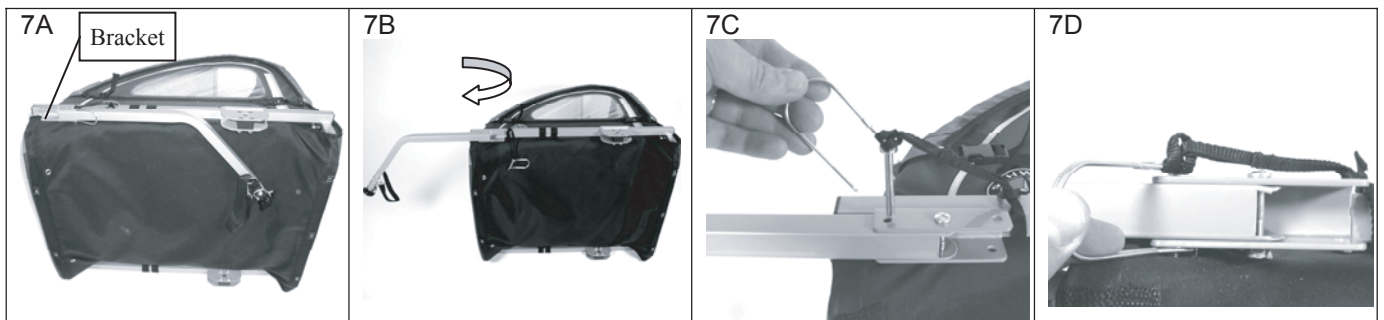

- 7A. Lay the trailer on its side with the tow bar at the top and undo the lock pin from the bracket.
- 7B. Pivot the tow bar all the way forward until the shaft comes to rest in the front part of the bracket.
- 7C. Insert the lock pin shaft all the way through the forward holes in the bracket and tow bar.
- 7D. Hook the loop over the end of the shaft and make sure the pin is secure.

STEP 8 Coupler attachment for bikes with rear hub nuts.

(Note: If your bicycle rear wheel has a quick-release rear axle please proceed to Steps 10 & 11)

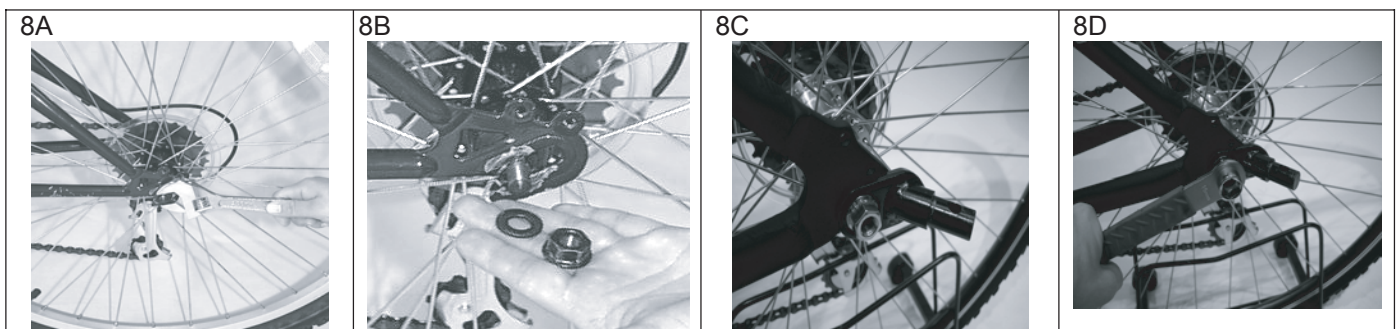

- 8A. Loosen the rear bike hub nut with a wrench.
- 8B. Remove the hub nut and washer from the bike.
- 8C. Position the coupler plate over the axle. Replace the bike hub nut and washer and tighten by hand.
- 8D. Tighten the bike hub nut securely with a wrench.

STEP 9 Attach trailer tow bar to bike

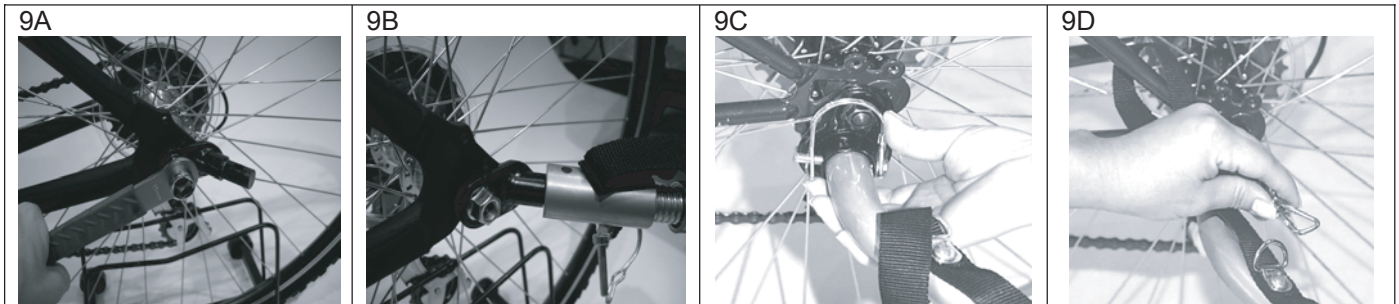

- 9A. Tighten the bike hub nut securely with a wrench.
- 9B. Locate the front end of the tow bar around the coupler.
- 9C. Push the quick release pin through the holes in the tow bar and the coupler and fasten securely.
- 9D. Loop safety strap around bike frame and clip the end into the "D" ring at the end of the tow bar.

⚠ WARNING Safety strap must be attached to the bike frame when using this product.

STEP 10 Coupler attachment for bikes with quick-release rear axles.

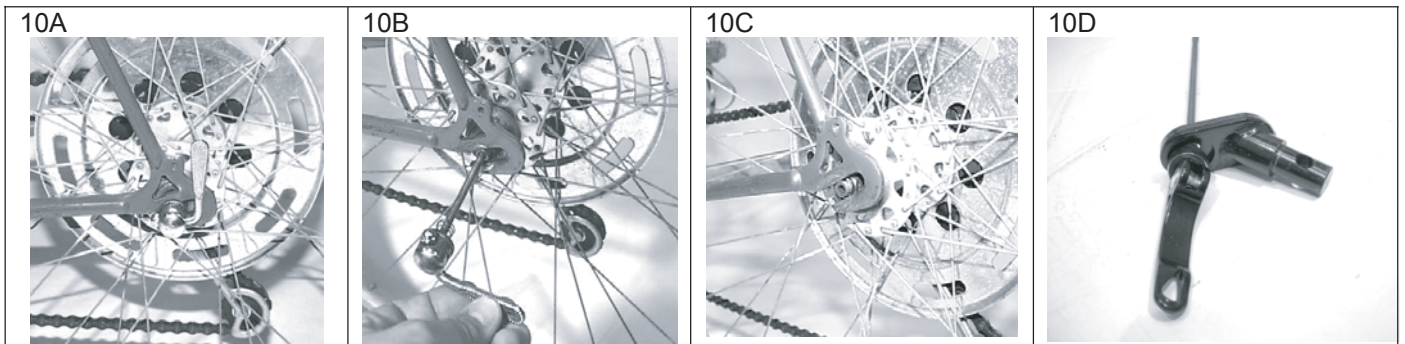

- 10A. Flip open the quick-release lever, and remove the nut and spring from the opposite side.
- 10B. Hold the lever and pull the axle skewer with spring out.
- 10C. Completely remove the skewer but leave the wheel in place.
- 10D. Slide the coupler plate and tab washer onto the skewer. **IMPORTANT!** The larger diameter end of the conical spring should face outwards, towards the QR lever.

STEP 11 Attach trailer tow bar to bike

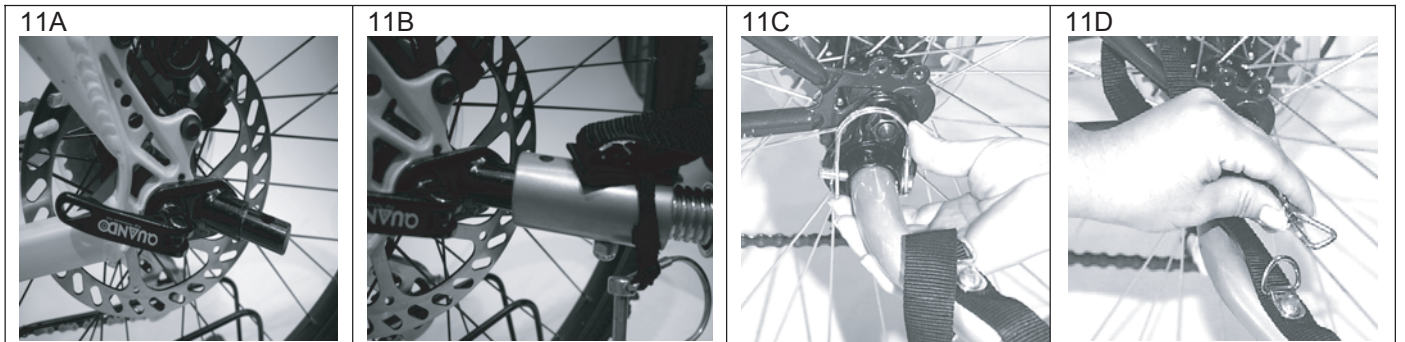

- 11A. Insert end of skewer back through wheel hub.
- 11B. Replace the spring (wide end out) over the end of the skewer, followed by the nut. Tighten the nut by hand and clamp the lever down (F).
- 11C. Insert the end of the trailer tow bar into the large hole and fasten the Q/R pin.
- 11D. **IMPORTANT!** Loop the safety strap around the bike frame and clip the end into the "D" ring at the end of the tow bar (H).

⚠ WARNING Safety strap must be attached to the bike frame when using this product.

STEP 12 Install the safety flag

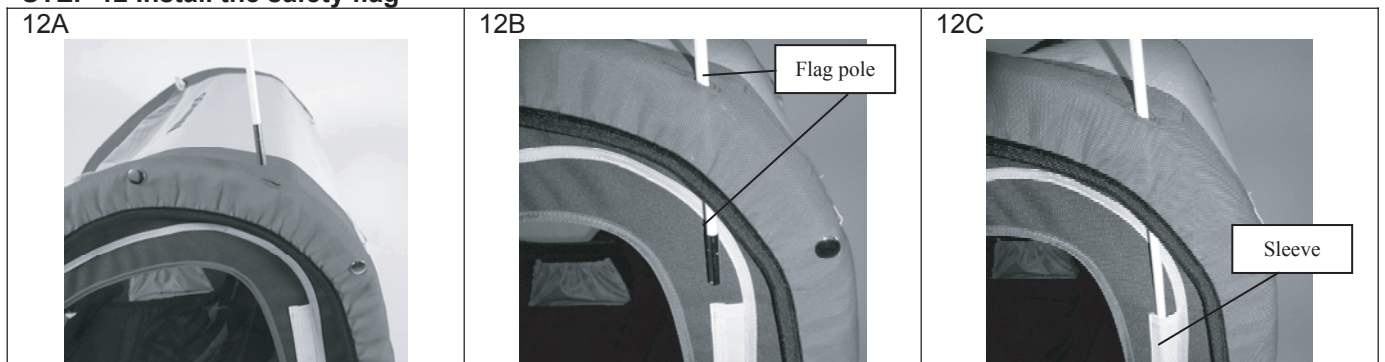

- 12A. Connect the flagpole sections and find the small opening near the top left edge of the canopy.
- 12B. Slide the end of the flagpole through the opening in the canopy.
- 12C. Slide the pole all the way down into the flag pole sleeve near the rear corner.

⚠ WARNING Always use the safety flag when pulling this trailer!

STEP 1 Proper use of the 5-point safety harness for one or two children

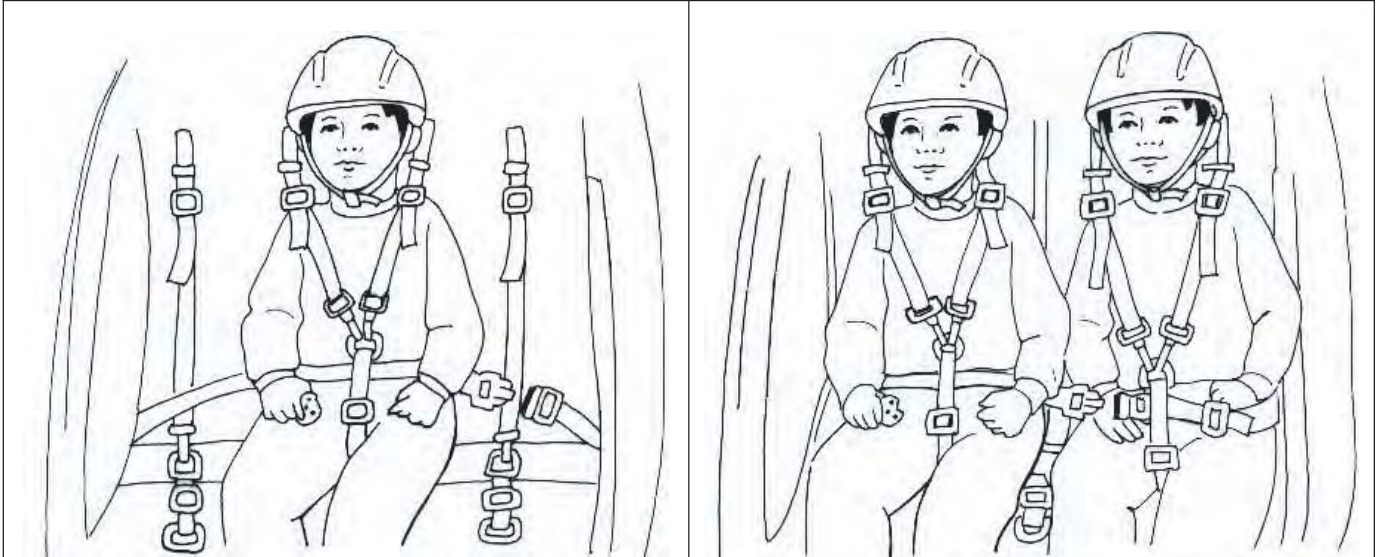

▲WARNING To avoid serious injury children should always wear the seat belt and shoulder straps!

Proper seating position for one child

- ▲ Undo the lap belt buckle and seat the child in the centre of the trailer/stroller.
- ▲ Buckle the lap belt over the child's lap, and pull the strap until the belt is snug.
- ▲ Place the two centre shoulder straps over the child's shoulders, and clip both straps into the "D" ring of the centre crotch strap.
- ▲ Adjust the shoulder strap height according to the height of the child, then pull the straps until they are snug.
- ▲ **IMPORTANT! Adjust the straps so that the crotch strap and shoulder straps meet at the child's stomach level, not at chest level!**
- ▲ Clip the outer shoulder strap on either side into the "D" ring of the outer crotch strap directly below. This will keep the straps that are not in use out of the way.

Proper seating position for two children

- ▲ Undo the lap belt buckle and seat the children side by side in the trailer/stroller.
- ▲ Buckle the lap belt over both children's laps, and pull the strap until the belt is snug. (Note: There is only one lap belt for both children.)
- ▲ Place one outer pair of shoulder straps over the shoulders of the child seated on that side, and clip both straps into the "D" ring of the outer crotch strap directly below.
- ▲ Adjust the shoulder strap height according to the height of the child, then pull the straps until they are snug.
- ▲ **IMPORTANT! Adjust the straps so that the crotch strap and shoulder straps meet at the child's stomach level, not at chest level!**
- ▲ Repeat for the child seated on the other side. (Note: The centre crotch strap will not be clipped to any shoulder straps.)

Entering and exiting the passenger compartment

1. Unclip the front panel clasps near the front corners of the trailer/stroller.
2. Fold the front flap down and underneath the trailer/stroller so that it is out of the way.
3. Assist children as they enter and exit the passenger compartment.

REMOVAL, DISASSEMBLY, AND STORAGE INSTRUCTIONS

Removal of the trailer from the bike

1. Remove children from inside the passenger compartment.
2. Unclip the tow bar safety strap from the "D" ring.
3. Loop the strap back around the bike frame tube so that the strap is free of the bike frame.
4. Clip the end of the strap back on to the tow bar "D" ring.
5. Remove the quick-release pin from the tow bar coupler.
6. Slide the tow bar out of the tow bar coupler plate and re-insert the quick-release pin into the holes at the end of the tow bar. **The coupler plate may remain attached to the bike.**
7. Set the front end of the trailer on the ground.

Storage

1. Remove the flag and pole and separate the pole sections.
2. Remove the rear wheels and set them to the side.

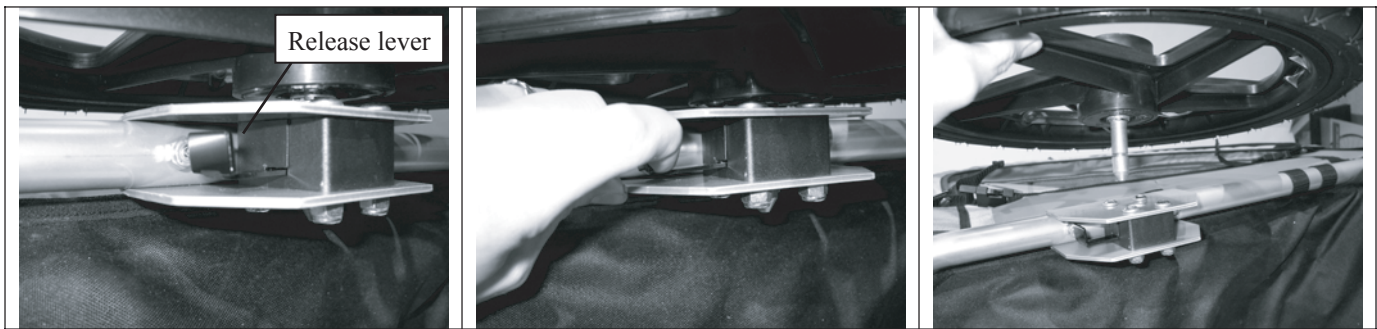

The release levers are located between the wheel bracket plates below the frame near the rear of the trailer. There is one lever on each bracket. They can be accessed from the rear.

Release the axle by pulling the release lever straight out and holding it in place.

Slide the wheel out of the bracket, then let go of the lever. Repeat for the other wheel.

3. Remove the quick-release pin from the tow bar bracket at the front corner of the trailer.
4. Fold the tow bar back underneath the trailer, and replace the quick-release pin through the tow bar and bracket.
5. Place all loose items inside the passenger compartment, and close the rain cover.
6. Release the quick release safety pins on the canopy sides and top and carefully fold the trailer compartment flat. **Use caution to avoid getting pinched!**
7. Store the trailer in a dry place. If the storage area will get hot, release some of the air from the tyre inner tubes to prevent excessive expansion or popping.

⚠ WARNING Do not use cleaning solvents! Clean only with mild soap and water!

Prior to each use

⚠ WARNING Ensure your bicycle is in good working order before use and certainly before attaching this trailer.

Pay particular attention to the brakes, wheels and steering.

⚠ Make sure that all parts are in good working order, and that no parts are missing. **Do not use this product if any parts are broken or missing!**

⚠ Check all components and aspects of this trailer before each use. Pay particular attention to the connecting devices; frame; safety harness; tyres and wheels for safe condition.

⚠ Check that all fasteners and bolts are securely tightened.

⚠ If you have any questions concerning the proper use of this product after it has been stored, please contact a qualified technician.

SAFE TOWING TIPS

- ⚠ **WARNING** Use a foot pump or hand pump to inflate tyres! Pressurized air hoses can cause over-inflation!
- ⚠ **WARNING** Accessories or parcels placed in trailer/stroller may cause it to become unstable!
- ⚠ **WARNING** Never use this trailer/stroller if it becomes damaged!
- ⚠ **WARNING** To avoid serious injury, children should always wear the seat belt and the shoulder straps!
- ⚠ **WARNING** Never leave children unattended in or around this trailer!
- ⚠ **WARNING** Make sure your bike brakes work properly! Braking distance is increased when pulling a trailer!
- ⚠ **WARNING** This trailer is wide! Allow extra clearance near kerbs, signs, parked cars, and other obstacles!
- ⚠ **WARNING** A bicycle with trailer attached requires a wide turning radius! Do not turn sharply!
- ⚠ **WARNING** Each child must wear an approved safety helmet when riding in this product in trailer mode!
- ⚠ **WARNING** Never remove protective canopy when children are in the trailer!
- ⚠ **WARNING** Always use the safety flag when pulling this trailer!
- ⚠ **WARNING** When pulling one child in the trailer, seat him/her in the centre!
- ⚠ **WARNING** Do not ride over kerbs! Avoid bumps and holes! Always signal your turns!
- ⚠ **WARNING** Use extra caution when turning on uneven road surface, and going downhill!
- ⚠ **WARNING** Not for use at high speeds! Do not exceed 10 MPH!
- ⚠ **WARNING** Never ride a bike or pull this trailer at night!
- ⚠ **WARNING** Be aware of exposure hazards such as wind-chill and heat exhaustion by less-active trailer passengers in prolonged exposure in colder temperatures, or by extended periods in warmer temperatures without adequate ventilation and hydration.

If you have any questions about the safe use or assembly of this product, please contact one of our Customer Service Representatives on 01332 274242 or by e-mail at customer.service@moorelarge.co.uk